

## WALL BRACKETS KIT

For the installation it is recommended to use the wall brackets provided by Cordivari, with different sizes depending on model. The kit includes:

- 2 wall brackets
- 2 plastic nogs

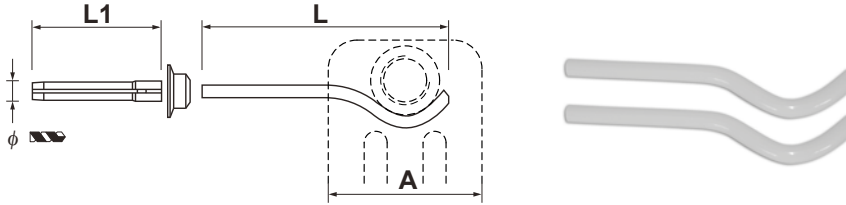

### HOW TO CALCULATE THE NUMBER OF WALL BRACKETS REQUIRED.

Always remember to consider both the Dry Weight of the radiator and its water content.

N° Columns	Art. nr.	∅ Nogs (mm)	L (mm)	L1 (mm)	max load [kg] kit
2	5991990310378	12	179	100	150
3	5991990310379	12	207	100	100
4	5991990310380	15	223	111	200
5	5991990310381	15	254	111	160
6					80

The code nr of the chart refer to standard colour white R01 RAL 9010; colours different from standard are supplied exclusively with the matching coloured radiator. Colour surcharge indicated in colour chart at page 486.

#### Eg: an Ardesia radiator consisting of:

n° columns: 4 - Height: 1000 - n° elements: 48

Total Dry Weight of 1 section, water included:  $2.96 * [\text{Dry Weight of empty section}] + 1.84 *$

[Dry Weight of water contained in the section] = total kg. 4.8.

Total Dry Weight of the whole radiator:  $4.8 \text{ kg} \times 48 [\text{sections}] = 230.4 \text{ kg}$

No. of fixing kits to order:  $230.4 \text{ kg} [\text{total Dry Weight of the radiator}] / 200 [\text{max Dry Weight that 1 wall brackets kit can take for Ardesia® 4 columns}] = 1.15$ . The number of kits necessary in this case is 2 - Code Nr. **5991990310380**.

(\*) Above data are taken from the relevant technical table (see page 214).

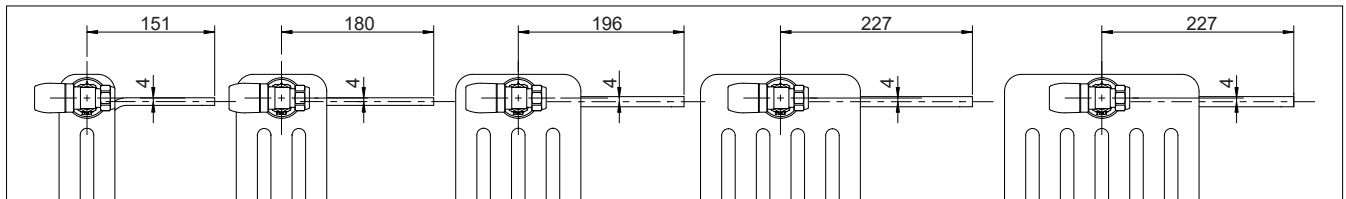

**Max. number of sections** that can be supported by a pair of brackets available for solid/masonry and perforated brick walls.

Height	N° COLUMNS				
	2	3	4	5	6
207	40	40	40	40	40
300	40	40	40	40	31
356	40	40	40	40	27
400	40	40	40	40	25
406	40	40	40	40	24
500	40	40	40	40	20
556	40	40	40	40	19
586	40	40	40	40	18
600	40	40	40	40	18
626	40	40	40	40	17
656	40	40	40	39	16
676	40	40	40	38	16
750	40	36	40	35	14
756	40	36	40	34	14
786	40	35	40	33	14
856	40	32	40	31	13
876	40	31	40	30	12
900	40	30	40	29	12
926	40	30	40	29	12
956	40	30	40	29	12
1000	40	28	40	27	11
1056	40	26	39	25	11
1200	40	23	35	23	9
1500	40	19	28	18	8
1656	39	17	26	17	7
1800	36	16	24	15	6
1856	35	15	23	15	6
2000	32	14	22	14	6
2056	32	14	21	13	6
2200	30	13	20	13	5
2500	26	12	17	11	5

#### DETERMINE THE BRACKET POSITION IN RELATION TO THE RADIATOR

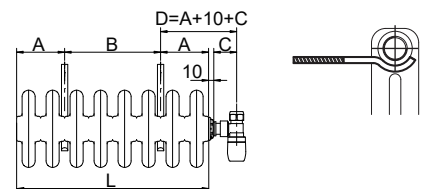

#### DETERMINE THE POSITION OF THE RADIATOR IN RELATION TO PIPES

#### REALIZE HOLES ON THE WALL IN RELATION TO THE PIPES POSITION

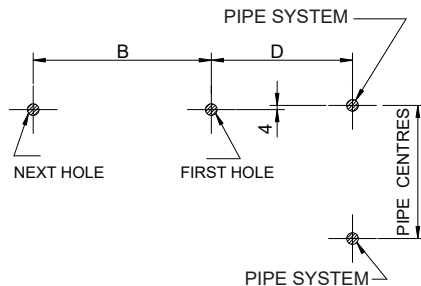

#### To determine A and B

- for N. of sections < 8:
  - A = 46
  - B = L - 92
- for N. of sections ≥ 8:
  - A = 92
  - B = L - 184 for 2 brackets
  - B =  $[(L - 184) / 2] - 23$  for 4 brackets and even N. of sections
  - B =  $(L - 184) / 2$  for 4 brackets and uneven N. of sections